

线路板开孔尺寸
P. C. B LAYOUT

按点示意图
SCHEMATIC

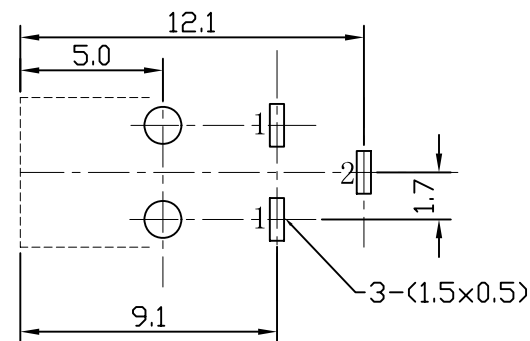
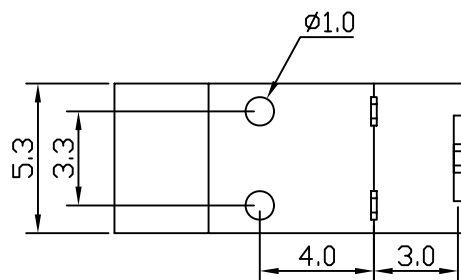
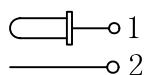

DIM	φ 0.7
APPD.	

技术要求:

1. 额定电负荷: DC 50V 1A;
2. 接触电阻: $\leq 0.03\Omega$;
3. 绝缘电阻: $\geq 100M\Omega$ (DC250V);
4. 耐压: 500VAC;
5. 插拔力: 5-20N;
6. 寿命: 5,000次。

4	基座	1	PBT				
3	平片	1	H62 BRASS	镀银			
2	弯片(包圆脚)	2	H62 BRASS	镀银			
1	插针	1	H59 BRASS	镀银			
序号	名称	数量	材料	电镀	编号	备注	
UNIT:MM	TYPE:	MODEL NO:		PAPER NO: A4		PAGE 1 OF 1	
	DC JACK	DC-002EA白色		TOLERANCE	ANGLES	SCALE	VER
				± 0.15	± 1.5°	3:1	1
DESIGNER BY:							
CHECK BY:							
APPROVED BY:							