

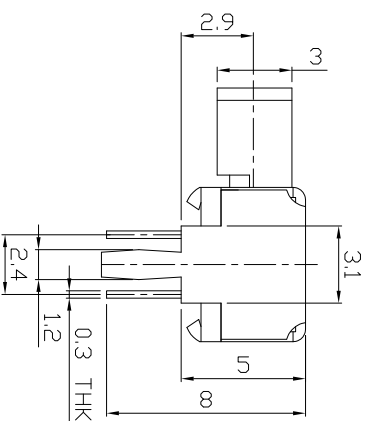

RoHS
Compliant
2002/95/EC

DIMENSIONS

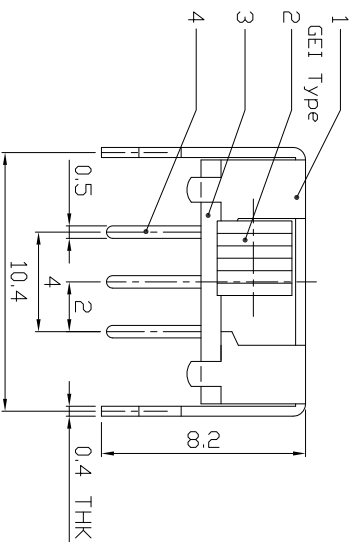
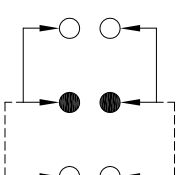
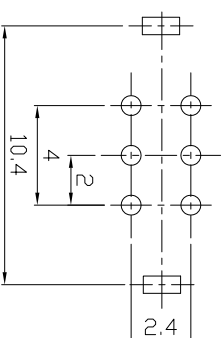
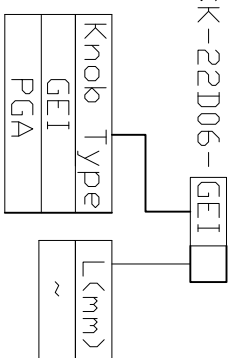
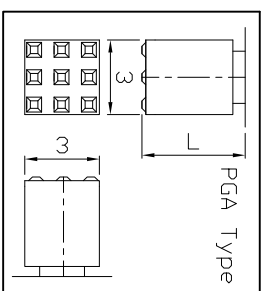
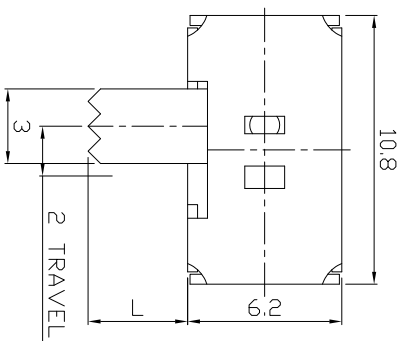

P.C.B LAYOUT BOTTOM VIEW

CIRCUIT DIAGRAM

ELECTRO-MECHANICAL CHARACTERISTICS

Refer to additional specifications

RATING	0.3A 50V DC
CIRCUIT	2P2T
CONTACT RESISTANCE	100mΩ MAX.
TIMING	NON-SHORTING
TRAVEL	2mm
OPERATING FORCE	250±100gf
OPERATING LIFE(cycles)	10,000

8									
7	CONTACT CLIP	PBS STRIP	2	NATURAL					
6	SPRING PLATE	SUS	1	NATURAL					
4	TERMINAL	BRASS STRIP	6	Ag PLATED					
3	BASE	PHENOLIC RESIN	1	NATURAL					
2	KNOB	PM	1	BLACK					
1	FRAME	STEEL STRIP	1	Ni PLATED					
ND.	PARTS	MATERIAL	Q'TY	FINISHING					

WITHIN 1.5mm: ±0.1mm
OVER 1.5mm: ±0.2mm

龙创中业电子（深圳）有限公司

TITLE: SLIDE SWITCH / HORIZONTAL

PART NO.: SK-22D06

DR: *Rocky* 2016/06/24

CHKD: *Rocky* 2016/06/24

SCALE: 4:1

DWG NO.: ADL-22D06

SCALE SHEET: 1/1

REV. A

APPLD:

CUSTOMER DRAWING