

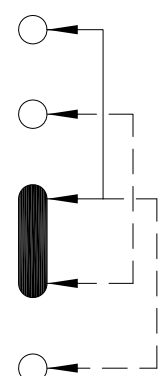

RoHS
Compliant
2002/95/EC

DIMENSIONS

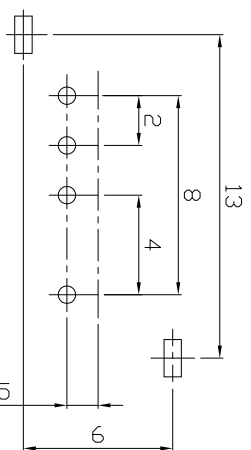
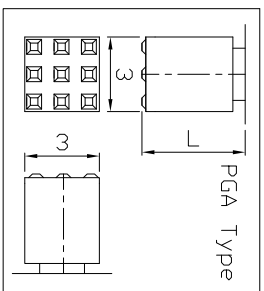
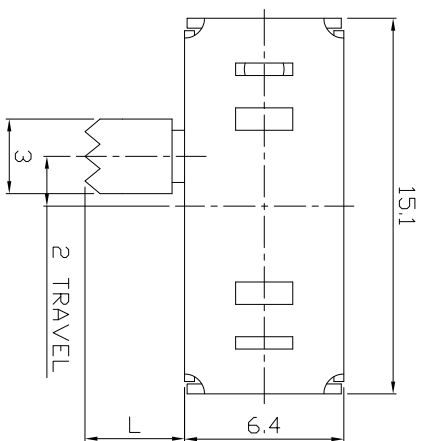

MODEL CODE

SK-13D12-GEI

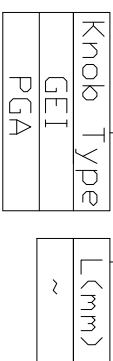

P.C.B LAYOUT BOTTOM VIEW

CIRCUIT DIAGRAM

ELECTRO-MECHANICAL CHARACTERISTICS

Refer to additional specifications

RATING	0.3A 50V DC
CIRCUIT	1P3T
CONTACT RESISTANCE	100mΩ MAX.
TIMING	SHORTING
TRAVEL	2mm
OPERATING FORCE	250±100gf
OPERATING LIFE(cycles)	10,000

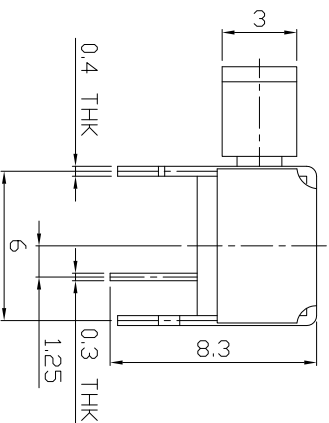
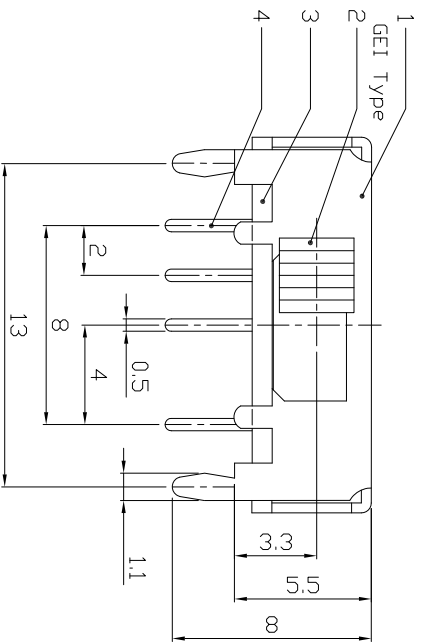

8										
7										
6	SPRING PLATE	SUS	1	NATURAL	WITHIN 1.5mm: ±0.1mm					
5	CONTACT CLIP	PBS STRIP	1	AG PLATED	OVER 1.5mm: ±0.2mm	UNIT'S	mm	MAT'L	SEE NOTE	
4	TERMINAL	BRASS STRIP	4	AG PLATED				FINISH	SEE NOTE	
3	BASE	PHENOLIC RESIN	1	NATURAL				SEE NOTE		
2	KNOB	POM	1	BLACK				Q'TY	1	
1	FRAME	STEEL STRIP	1	Ni PLATED				CHK'D:	Stucky	2016/06/23
ND.	PARTS	MATERIAL	Q'TY	FINISHING				APP'D:		

龙创中业电子（深圳）有限公司

TITLE: SLIDE SWITCH / HORIZONTAL
PART NO.: SK-13D12

DR: Stucky 2016/06/23
DWG NO.: ADL-13D12

SCALE: 3:1
SHEET: 1/1
REV: A
CUSTOMER DRAWING

REV.	ECN.	NO.	APPL.