



RoHS
Compliant
2002/95/EC

MODEL CODE

SK-22D13-GBG

REV.	ECN.	NO.	APPD.

DIMENSIONS

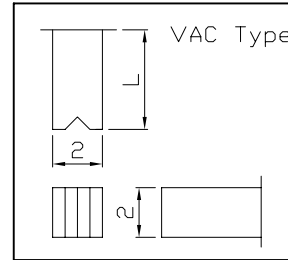
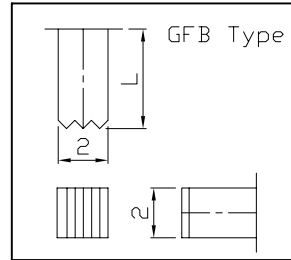
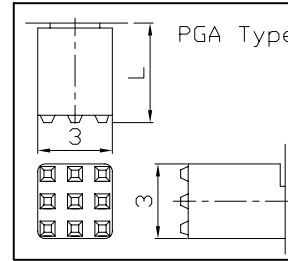
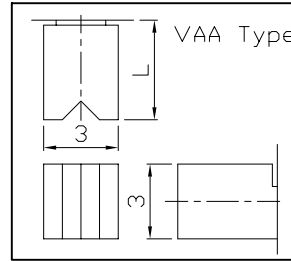
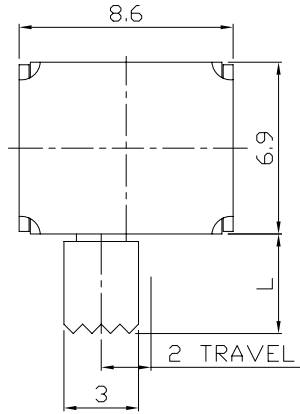

Knob Type

GBG
VAA
PGA
GFB
VAC

L(mm)

~

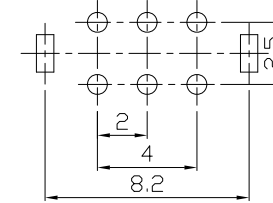

P.C.B LAYOUT
BOTTOM VIEW

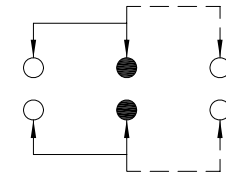

CIRCUIT DIAGRAM

ELECTRO-MECHANICAL CHARACTERISTICS

Refer to additional specifications

RATING	0.3A 30V DC
CIRCUIT	2P2T
CONTACT RESISTANCE	30mΩ MAX.
TIMING	SHORTING
TRAVEL	2mm
OPERATING FORCE	250±100gf
OPERATING LIFE(cycles)	10,000

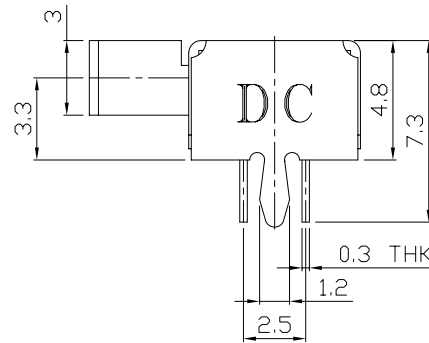
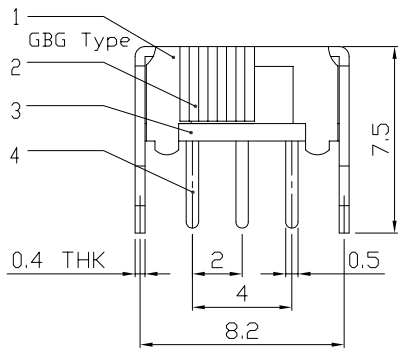

8							
7							
6	SPRING PLATE	SUS	1	NATURAL			
5	CONTACT CLIP	PBS C5210R-EH	2	Ag CLAD			
4	TERMINAL	BRASS STRIP	6	Ag PLATED OVER Ni PLATED			
3	BASE	PHENOLIC RESIN	1	NATURAL			
2	KNOB	POM/NYLON+F.G+94V0	1	BLACK			
1	FRAME	STEEL STRIP	1	Ni PLATED			
NO.	PARTS	MATERIAL	Q'TY	FINISHING			

THESE DRAWINGS AND SPECIFICATIONS ARE THE PROPERTY OF ACCURATE INNOTECH INC AND SHALL NOT BE REPRODUCED, COPIED OR USED IN ANY MANNER WITHOUT THE PRIOR WRITTEN CONSENT OF ACCURATE INNOTECH INC.

WITHIN 1.5mm: ±0.1mm	UNITS mm
OVER 1.5mm: ±0.2mm	MAT'L
	SEE NOTE
	FINISH
	SEE NOTE
	Q'TY

龙创中业电子(深圳)有限公司

TITLE: SLIDE SWITCH / HORIZONTAL PART NO.: SK-22D13

DR: Ricky 2015/12/15 DWG NO.: ADJ-22D13

CHKD: Ricky 2015/12/15

APPD:

SCALE	SHEET	REV.	CUSTOMER DRAWING
4:1	1/1	A	