

DIMENSIONS

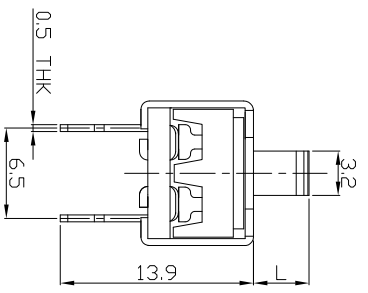

MODEL CODE

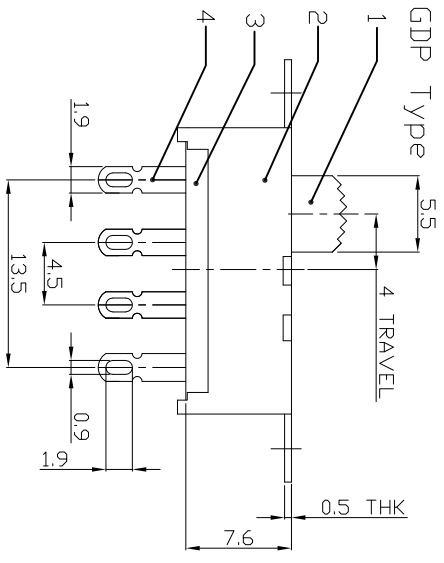
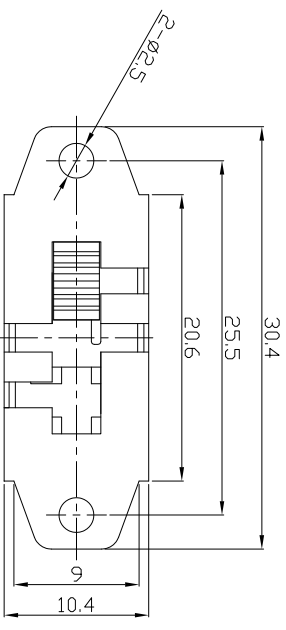
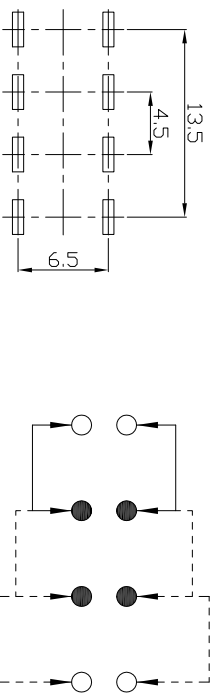
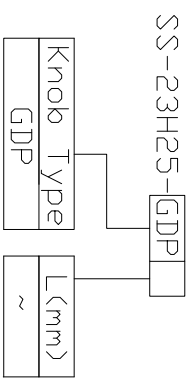

P.C.B LAYOUT
BOTTOM VIEW

CIRCUIT DIAGRAM

ELECTRO-MECHANICAL CHARACTERISTICS

Refer to additional specifications

RATING	3A 125V AC
CIRCUIT	2P3T
CONTACT RESISTANCE	100mΩ MAX.
TIMING	NON-SHORTING
TRAVEL	4mm
OPERATING FORCE	350±150gf
OPERATING LIFE(cycles)	10,000

8				WITHIN 1.5mm: ±0.1mm OVER 1.5mm: ±0.2mm	UNITS mm	龙创中业电子（深圳）有限公司		
7	SPRING PLATE	PBS STRIP	3	NATURAL	MAT'L SEE NOTE	TITLE: SLIDE SWITCH / VERTICAL	PART NO.:	SS-23H25
6	CONTACT	COPPER STRIP	2	Ag PLATED	FINISH SEE NOTE	DR:	2015/10/08	DWG NO.:
5	TERMINAL	COPPER STRIP	8	Ag PLATED	Q'TY	CHKD:	2015/10/08	ADL-23H25
4	BASE	PHENOLIC RESIN	1	BLACK	DR:	2015/10/08	SCALE	1/1
3	FRAME	STEEL STRIP	1	NI PLATED	Q'TY	APPD:	21	REV.:
2	KNOB	POW	1	BLACK	APPD:	21	1/1	A
1	PARTS	MATERIAL	Q'TY	FINISHING	APPD:	21	1/1	A

THESE DRAWINGS AND SPECIFICATIONS ARE THE PROPERTY OF ACCURATE INNOTECH INC. AND SHALL NOT BE REPRODUCED, COPIED AND/OR DISTRIBUTED WITHOUT THE WRITTEN CONSENT OF ACCURATE INNOTECH INC.

REV.	ECN.	NO.	APPL.