

DIMENSIONS

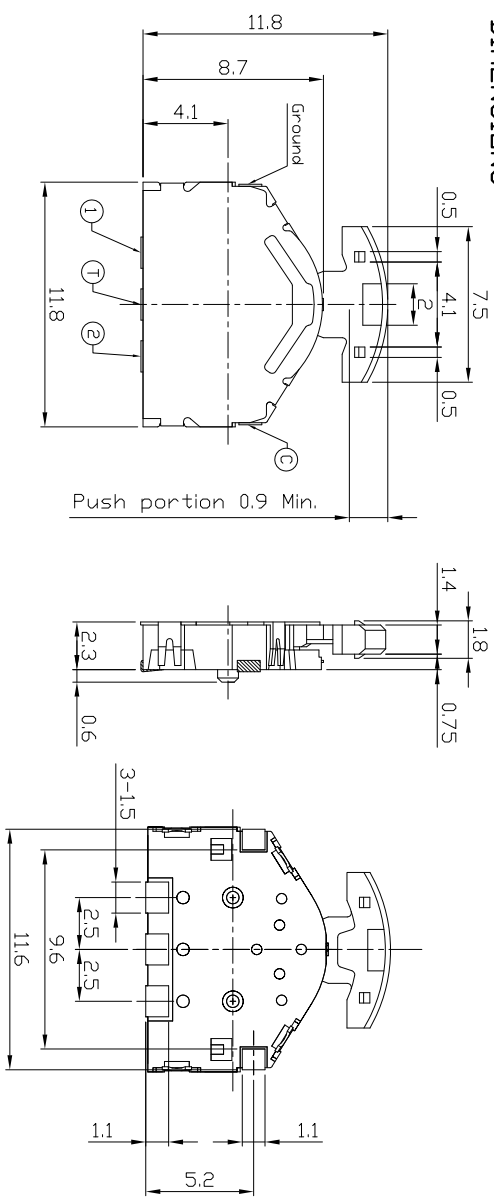

P.C.B MOUNTING PATTERN DIMENSION
 The following soldering patterns are recommended for reflow soldering

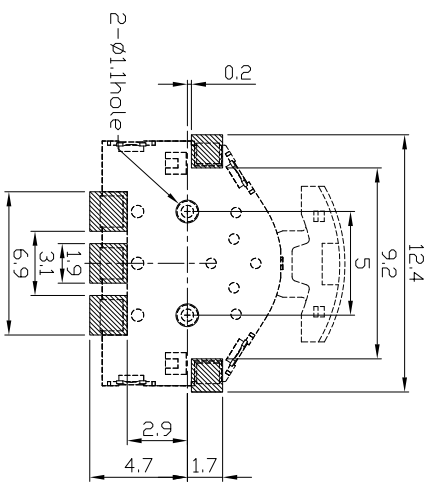

CODE TABLE

PRODUCT IMAGE

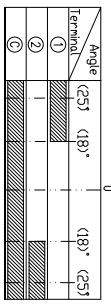

CIRCUIT DIAGRAM

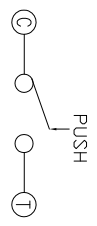

ELECTRO-MECHANICAL CHARACTERISTICS

Refer to additional specifications

Rating	DC 5V 10mA
Output Voltage	1V Min. at 5V 1mA
Operating Force	Lever 70±50gf
	Center 200±100gf
Travel	Center 0.9mm Min.
Operating Life(cycles)	100,000

E

UNITS	mm
MAT'L	
FINISH	
SEE NOTE	

DONGGUAN MINGJU ELECTRONICS CO.,LTD

PUSH LEVER SWITCH
 PART NO.: AL-1305A SERIES

DR: *Stacy* 2014/04/02
 CHKD: *Stacy* 2014/04/02
 APPD: *Stacy* 2014/04/02
 SCALE 1:1
 SHEET 1/1
 REV. A
 CUSTOMER DRAWING

1

2

3

4

5

6

7

E