

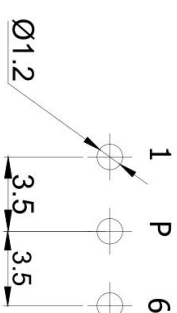

RoHS
Compliant
2002/95/EC

DIMENSIONS

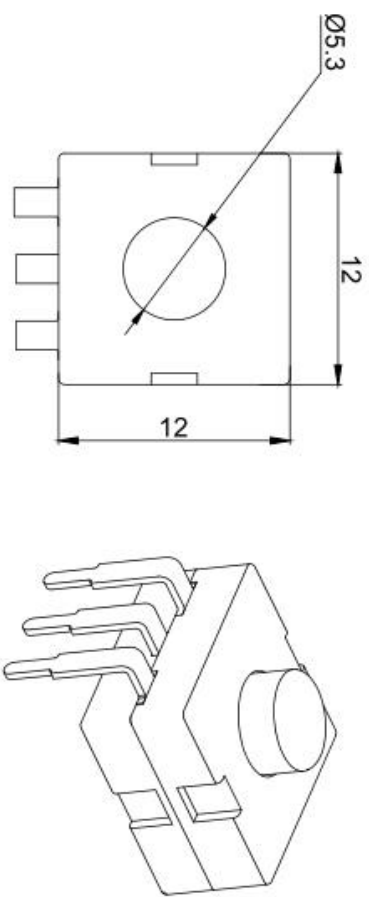

SWITCHING CIRCUIT



P.C.B. LAYOUT

ELECTRO-MECHANICAL CHARACTERISTICS

Refer to additional specifications

RATING	DC30V 1A
CIRCUIT	
CONTACT RESISTANCE	100mΩ MAX.
TIMING	NON-SHORTING
OPERATING MODE	SELF-LOCK
STROKE	1.5mm
OPERATING FORCE	700 ± 100gf
OPERATING LIFE(cycles)	20000

9	CONTACT CLIP	PBS STRIP	2	AG PLATED
8	TERMINAL	BRASS STRIP	6	AG PLATED
7	BASE	PHENOLIC RESIN	1	NATURAL
6	FRAME	STEEL STRIP	1	Ni-PLATED
5	SPRING PLATE	PBS STRIP	1	NATURAL
4	CAM STICK	PBS WIRE	1	NATURAL
3	SPRING	STEEL WIRE	1	Ni-PLATED
2	BLOCK	STEEL STRIP	1	Ni-PLATED
1	KNDB	PA66	1	BLACK
ND	PARTS	MATERIAL	Q'TY	FINISHING

WITHIN 1.5mm±0.1mm
OVER 1.5mm±0.2mm

DONGGUAN MINGJU ELECTRONICS CO.,LTD

UNITS	mm
MAT'L	SEE NOTE
FINISH	SEE NOTE
Q'TY	APP'D:
TITLE:	PUSH SWITCH / HORIZONTAL
PART NO.:	TS202
DWG NO.:	TS202
SCALE	1/1
SHEET	1/1
REV.	A
CUSTOMER	DRAWING

REV.	ECN.	NO.	APPL.